

# 50Ω Adapter 1.0mm Female - 2.4mm Male

Part Number: 10-24-FM



## Specifications

Electrical Specifications at 25° C, all specifications are subject to change without notice at any time. Rev. A

|  |                              |
|--|------------------------------|
| Frequency Range                        | DC-50GHz                     |
| VSWR (Max.)                            | 1.25:1                       |
| Insertion Loss (Max.)                  | 0.35dB                       |
| Durability (Min.)                      | 1000 cycles                  |
| Insulation Resistance (Min.)           | 5000 MΩ                      |
| Dielectric Withstanding Voltage (Min.) | 500 Vrms                     |
| Operating Temperature                  | -65° C~+165° C               |
| Outer Conductor                        | Stainless Steel Passivated   |
| Center Conductor                       | Gold-Plated Beryllium Copper |
| Dielectric                             | PEI                          |

## Outline Drawing

Note. Unless otherwise specified, Decimal Note tolerance: ±0.2

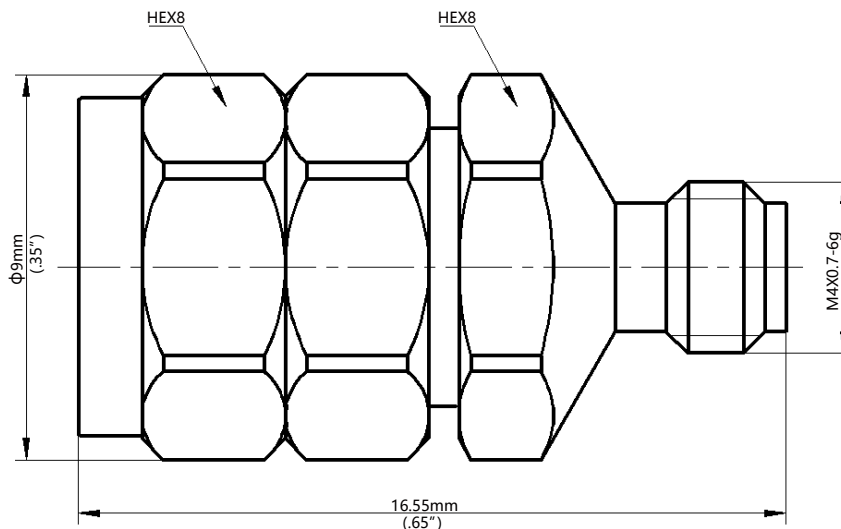

# 50Ω Adapter 1.0mm Female - 2.4mm Male

Part Number: 10-24-FM

Electrical Specifications at 25° C, all specifications are subject to change without notice at any time. Rev. A

## Typical Graph

