

Power Divider/Combiner

Model P02N003670 Rev.A

0.3-67GHz 2-Way Power Divider/Combiner, Coaxial connector

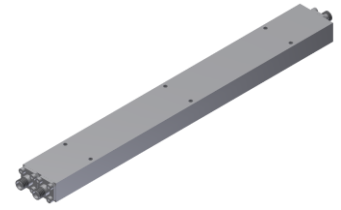

Specifications

All specifications are subject to change without notice at any time

Frequency Range	GHz	0.3-18	18-40	40-50	50-67
Sum VSWR	:1 (Max.)	1.5	1.6	1.6	1.7
Distri. VSWR	:1 (Max.)	1.5	1.6	1.6	1.7
Insertion Loss ¹	dB(Max.)	2.8	5.1	6.1	7.9
Amp. Unbalance	dB(Max.)	±0.3	±0.4	±0.5	±0.6
Phase Unbalance	Deg. (Max.)	±4	±6	±7	±9
Isolation	dB(Min.)	16	18	18	18
Power ²	W(Max.)	CW: FOR 12, REV 1; Peak: 1000			
Weight	g(Max.)	235	Dimension ³ mm (LxWxH)	216.5x25.8x12.7	
Interface	Stainless steel connector; Sum: 1.85mm [F], Distri.: 1.85mm [F]				
Finishing	Alloy iridite				
Temperature	Operating: -55~+85°C; Storage: -55~+100°C				
Environmental	Per MIL-STD-202F, Method 107D, 204D, 213B (optional, contact supplier for detail info.)				
Eng. Customized	N/A				

- Note:
- Above Theoretical Loss 3dB
 - VSWR ≤ 1.2 required for forward CW; Amp. & phase unbalance required for reversed input signals
 - Unless otherwise specified, Decimal tolerance: x.±1; .x±0.5; .xx±0.1

Outline Drawing

