

# Power Divider/Combiner

## Model P02N003265 Rev.C

0.3-26.5GHz 2-Way Power Divider/Combiner, Coaxial connector

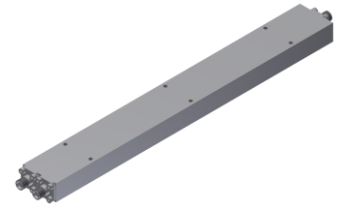

### Specifications

All specifications are subject to change without notice at any time

|                             |   |                               |                                   |                 |
|-----------------------------|---|-------------------------------|-----------------------------------|-----------------|
| Frequency Range             | GHz   | 0.3-8                         | 8-18                              | 18-26.5         |
| Sum VSWR                    | :1 (Max.)   | 1.5                           | 1.5                               | 1.6             |
| Distri. VSWR                | :1 (Max.)   | 1.5                           | 1.5                               | 1.6             |
| Insertion Loss <sup>1</sup> | dB(Max.)  | 1.4                           | 2.4                               | 3.4             |
| Amp. Unbalance              | dB(Max.)  | ±0.2                          | ±0.3                              | ±0.4            |
| Phase Unbalance             | Deg. (Max.)   | ±3                            | ±4                                | ±5              |
| Isolation                   | dB(Min.)  | 16                            | 18                                | 18              |
| Power <sup>2</sup>          | W(Max.)   | CW: FOR 30, REV 2; Peak: 3000 |                                   |                 |
| Weight                      | g(Max.)   | 235                           | Dimension <sup>3</sup> mm (LxWxH) | 216.5x25.8x12.7 |
| Interface                   | Stainless steel connector; Sum: SMA [F], Distri.: SMA [F]                               |                               |                                   |                 |
| Finishing                   | Alloy iridite   |                               |                                   |                 |
| Temperature                 | Operating: -55~+85°C; Storage: -55~+100°C   |                               |                                   |                 |
| Environmental               | Per MIL-STD-202F, Method 107D, 204D, 213B (optional, contact supplier for detail info.) |                               |                                   |                 |
| Eng. Customized             | N/A   |                               |                                   |                 |

Note: 1. Above Theoretical Loss 3dB

2. VSWR ≤ 1.2 required for forward CW; Amp. & phase unbalance required for reversed input signals

3. Unless otherwise specified, Decimal tolerance: x.±1; .x±0.5; .xx±0.1

### Outline Drawing

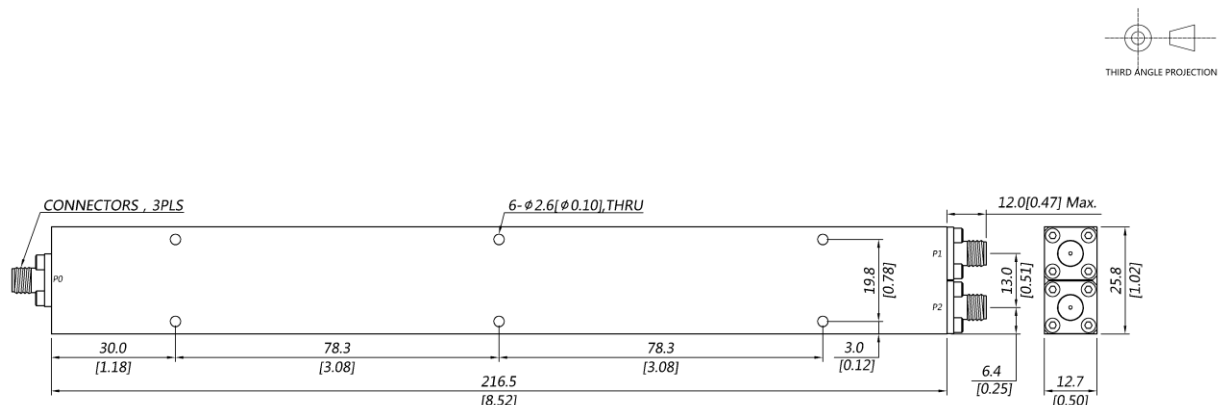

# Power Divider/Combiner

## Model P02N003265 Rev.C

0.3-26.5GHz 2-Way Power Divider/Combiner, Coaxial connector

### Typical Graph

Typical test temperature @25°C

